



# CITY OF MENDOTA

643 Quince Street Mendota, CA 93640  
(559) 655-4298 Fax: (559) 655-4064

## APPLICATION FOR FENCE PERMIT

Application Date: \_\_\_\_\_

Building Permit No: \_\_\_\_\_

Description of Work: \_\_\_\_\_

Location of Fence (Front, Back or Side): \_\_\_\_\_

New       Repair       Replace

Type of Fence:     Chain Link       Wood       Other \_\_\_\_\_

JOB ADDRESS: \_\_\_\_\_ CITY: Mendota, CA 93640

NEAREST CROSS STREET: \_\_\_\_\_

A.P.N.: \_\_\_\_\_ VALUATION: \$ \_\_\_\_\_

OWNER NAME: \_\_\_\_\_ PHONE: (    ) \_\_\_\_\_

ADDRESS: \_\_\_\_\_ CITY: \_\_\_\_\_ ZIP: \_\_\_\_\_

CONTRACTOR: \_\_\_\_\_ PHONE: (    ) \_\_\_\_\_

ADDRESS: \_\_\_\_\_ CITY: \_\_\_\_\_ ZIP: \_\_\_\_\_

CONTRACTOR LICENSE NO: \_\_\_\_\_ CONTRACTOR CLASS: \_\_\_\_\_

LICENSE: \_\_\_\_\_

I understand that the fence permit that I am applying for must meet all City of Mendota standards and that the fence must be located on the property that I am applying for. I also understand that the fence cannot and will not encroach onto my neighbor's property. I further understand that if this fence is built onto the City of Mendota's utility easement the city has the right to remove this fence to repair or replace water, sewer, or electrical services and the city will not be held liable or responsible for such removal of said fence. I/We are liable for such repairs as required to repair or replace fence that the city may have to remove for any city approved projects.

Yo entiendo que el permiso de cerco que estoy aplicando tiene que conceder con los requisitos de la Ciudad de Mendota. El cerco tiene que estar localizado en la propiedad que estoy aplicando. El cerco no puede invadir la propiedad de los vecinos. Yo entiendo que si construyo en los servicios de utilidad de la Ciudad de Mendota, la Ciudad tiene el derecho de remover este cerco reparar o reemplazar agua, drenaje o servicios eléctricos sin ser responsable de remover el cerco. Yo como aplicante soy responsable de las reparaciones si se requieren del cerco si la ciudad necesita removerlo por cualquier proyecto aprobado por la Ciudad de Mendota.

\_\_\_\_\_  
Applicant Signature

\_\_\_\_\_  
Date

\_\_\_\_\_  
Reviewed By

\_\_\_\_\_  
Date



## FENCE PERMIT REQUIREMENTS

### *What is the process to apply for a fence permit?*

1. Complete the fence permit application and a simple plot plan, drawn to scale, showing the proposed fence location in relationship to property (illustrated below.)
2. Call City Hall to schedule inspections
  - Block fence requires three inspections 1<sup>st</sup> lift (about 2 ft high and rebar), last lift, and final.

### SAMPLE FENCE SITE PLAN

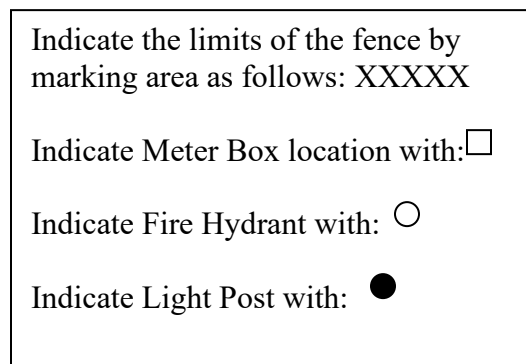
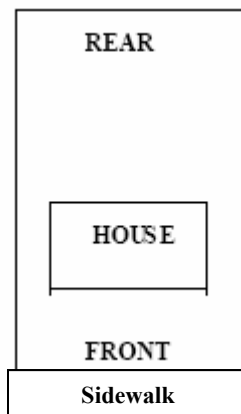

### *I don't know where my or my neighbor's property lines are located; can the City visit my property and find them?*

- No, only a commercial registered surveyor can physically locate property lines. Surveyors can be found in any Yellow Pages under "Surveyors – Land".

### *Permitted Fences, Hedges and Walls (Mendota Municipal Code 17.16.055)*

1. Fences, hedges and walls, not greater than six (6) feet in height, shall be permitted on or within all rear and side property lines on interior lots and on or to the rear of all front yard setback lines.
2. No fence, wall or hedge over three (3) feet in height shall be permitted in any required front yard reversed corner lot, except on parcels of five acres or more.
3. Fences or structures over six feet in height, to enclose tennis courts or other game areas located within the rear half of the lot, shall be composed of wire mesh capable of admitting at least ninety (90) percent of light as measured on a reputable light meter. Such fences shall be permitted in the required side or rear yard and subject to a conditional use permit.